

Copy and Paste Specifications

Maxi Dropped Ceiling (Beneath existing plasterboard / lath and plaster ceiling)

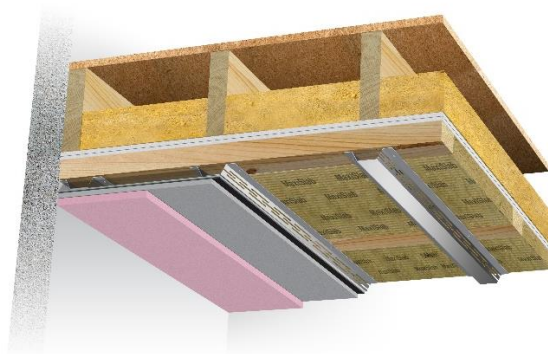

- **Manufacturer:**

- **Sound Reduction Systems Ltd**
- Web: www.soundreduction.co.uk
- Email: info@soundreduction.co.uk
- Tel / Fax: 01204 380074 / 01204 380957
- Product Ref: *Maxiboard*
- System Ref: *Maxi Dropped Ceiling*

- **Installation Detail:**

- 50 x 50mm timber battens fixed across existing ceiling @ 600mm centres.
- 50mm Maxi Slab (45kg/m³) installed between the timber battens
- 3000mm SRS Maxi Resilient Bars fixed @ 400mm centres across the battens.
- 1200 x 600 x 17mm Maxiboard acoustic boards fixed to SRS Maxi Resilient Bars with SRS Maxi Screws.
- SRS Gripfix used on all Maxiboard joints and SRS Acoustic Sealant used at perimeter. 9.5mm plasterboard fitted over the Maxiboard and finished as per manufacturer's instructions.

- **Notes:**

- This specification is not a substitute for the manufacturer's installation guide. Please contact SRS Ltd for full installation instructions and details of approved stockists.