

ACOUSTILAY ON CONCRETE FLOOR	
	IMPACT $\Delta L_w$ (dB)
Acoustilay 3 - without board	42
Acoustilay 15 - without board	42

IN ALL NON-DOMESTIC ENVIRONMENTS, SUCH AS OFFICES, HOSPITALS AND SCHOOLS, IT IS RECOMMENDED THAT ACOUSTILAY MDF IS INSTALLED ONTO THE ACOUSTILAY REGARDLESS OF THE FLOOR FINISH

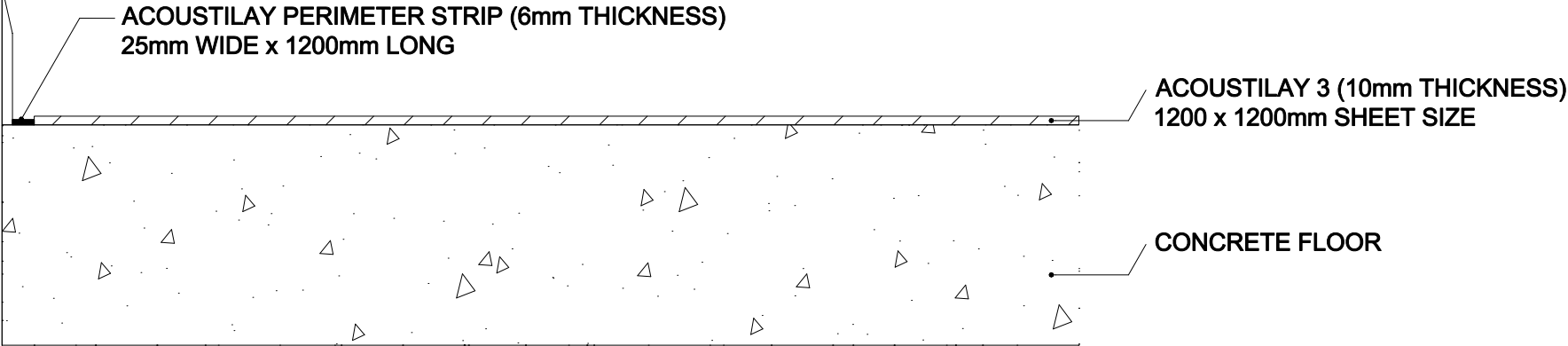

**SOUND REDUCTION SYSTEMS  
ACOUSTILAY ON A CONCRETE FLOOR**